

PARTS			
PART	DESCRIPTION	PART NO.	QTY
A	LEFT LEG ASSEMBLY	SA-00083	2
B	RIGHT LEG ASSEMBLY	SA-00084	2
C	SWIVEL SUPPORT ASSEMBLY	SA-00085	1
D	SEAT ASSEMBLY	SA-00089	1
E	ARM CONNECTOR ASSEMBLY	SA-00086	2
F	UNDER ARM SUPPORT	PRT-00146	2
G	LEFT ARM ASSEMBLY	SA-00087	1
H	RIGHT ARM ASSEMBLY	SA-00088	1
I	BACK ASSEMBLY	SA-00069	1

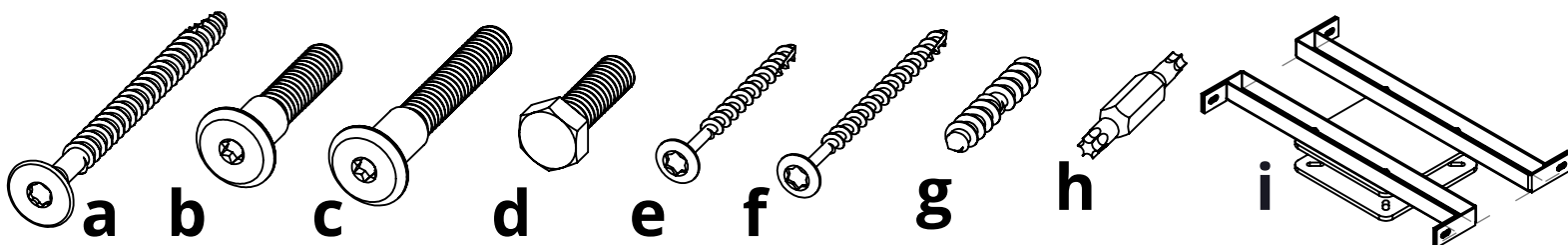

HARDWARE			
PART	DESCRIPTION	PART NO.	QTY
a	1/4"-10 X 3" LAG SCREW UNPAINTED	H-0000-S103	4
b	5/16" X 1-1/2" CHAIR BOLT	H-0000-CB51615	2
c	5/16" X 2-1/8" CHAIR BOLT	H-0000-CB516218	12
d	1" HEX BOLT 5/16" DIA	H-0000-HB1	4
e	#8 X 2" TORX SCREW	H-0000-S82	2
f	#8 X 2-1/2" TORX SCREW	H-0000-S825	4
g	DOUBLE SCREW	H-0000-DS	2
h	T25 & T20 TORX BIT	H-0000-CTD	1
i	COASTAL SWIVEL ASSEMBLY-GEN 3	H-0000-SAC3	1

Suggested Tools: Drill, Plastic Mallet, 1/2" Socket Wrench

Please read entire instructions before beginning

- 1.** Connect Parts **A** & **B** to Part **C** using Hardware **c** as shown

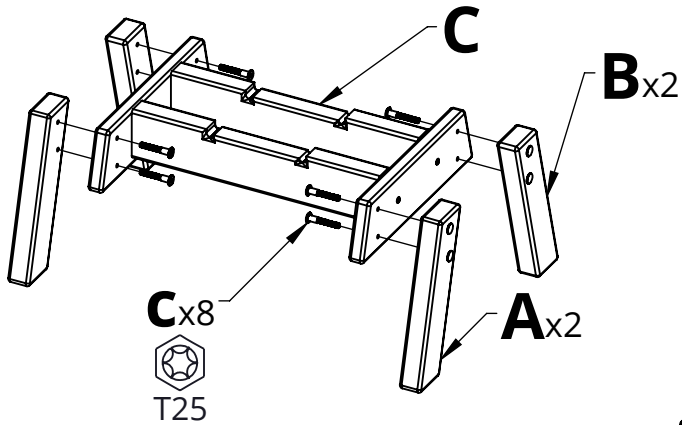

- 2.** Attach Hardware **i** to the previous assembly using Hardware **a**. Rotate the top half of the swivel 45 degrees to run screws through the bottom half.

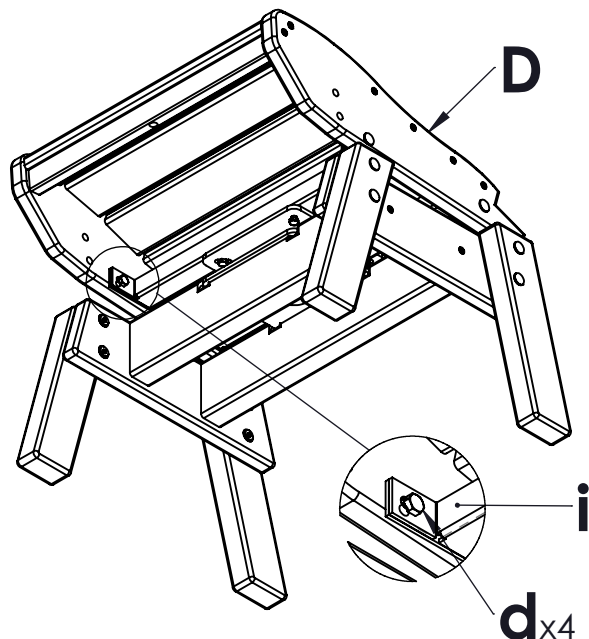
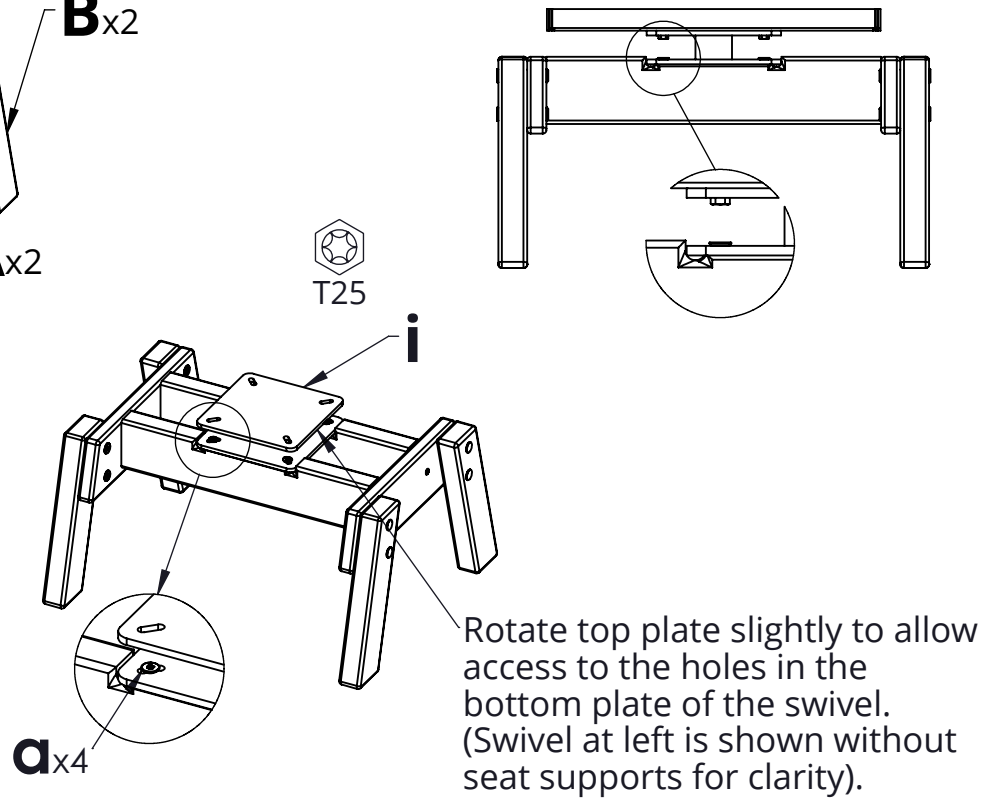

- 3.** Attach Seat Assembly **D** to the swivel assembly **i** using Hardware **d**.

Please read entire instructions before beginning

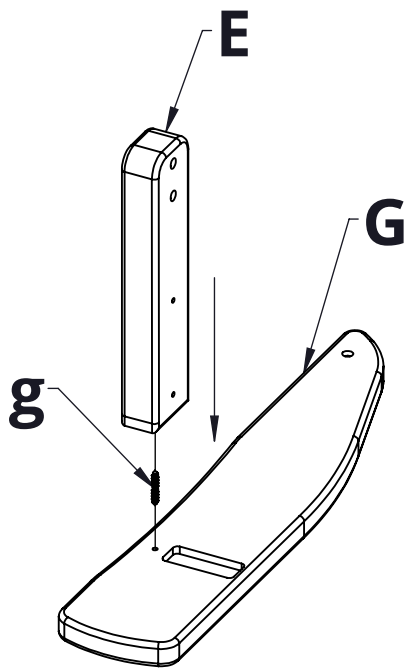

4. Attach Part **E** to Part **G** using Hardware **f**

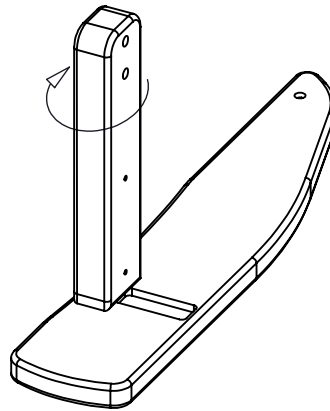

5. Rotate Part **E** clockwise until tight in the orientation shown

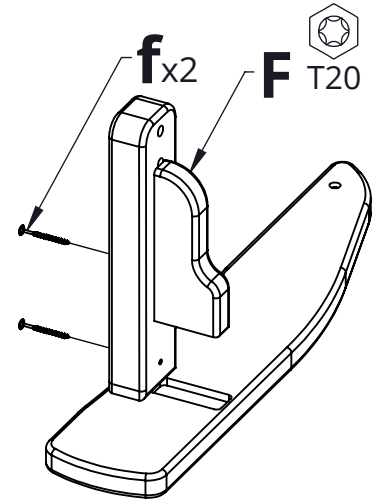

6. Place Part **F** into the pre cut slot and attach with Hardware **f**

7. Repeat steps 3-5 for Parts **H**, **E**, & **F**

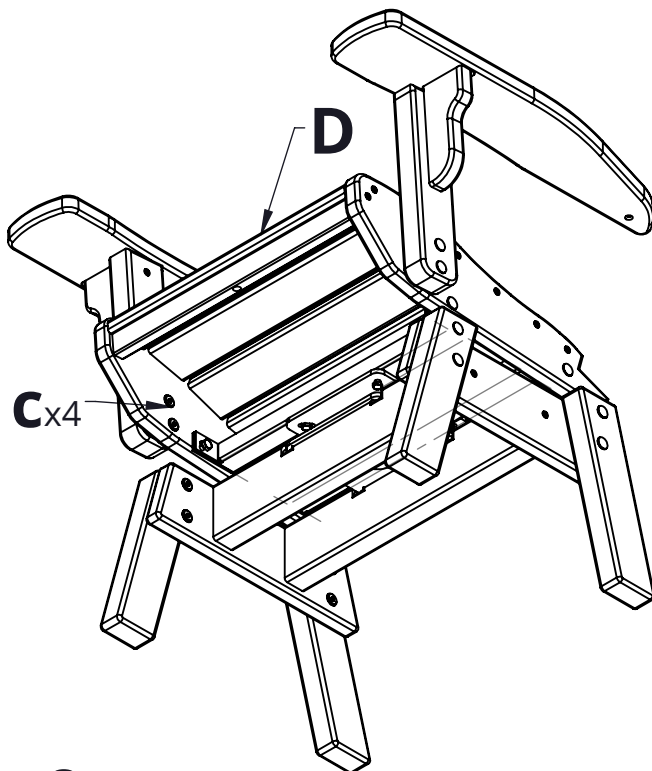

8. Attach the two arm assemblies to the seat base using hardware **c**.

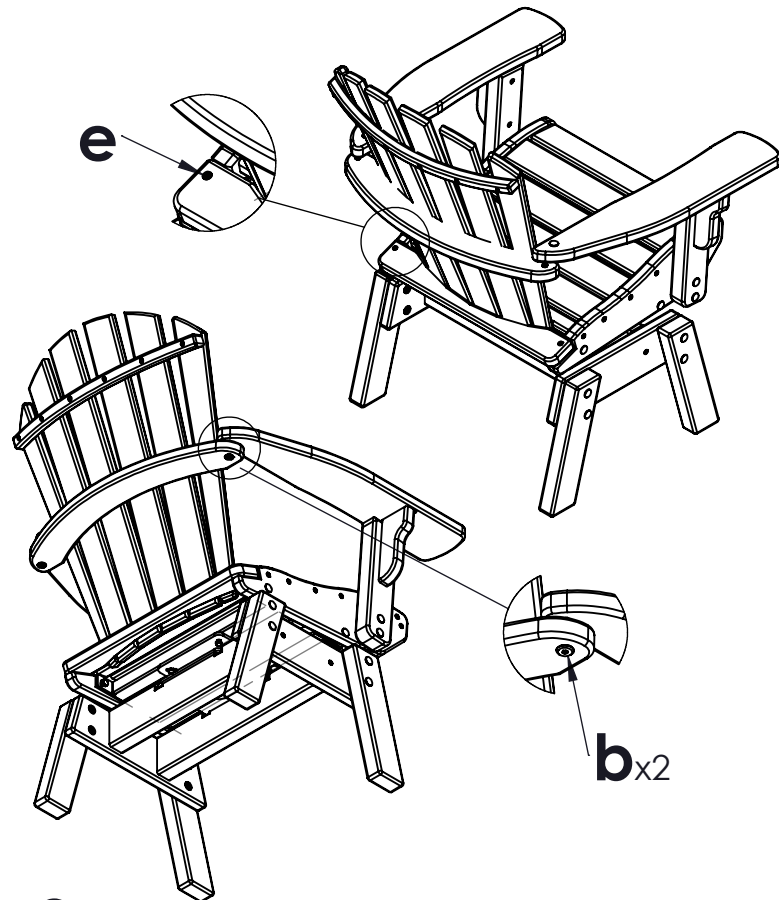

9. Attach Back Assembly **I** to the seat base using hardware **e**, 1 per side. Attach the Back Assembly center support to each arm using hardware **b**.