



#### Tools Required

5/32 Hex Key (Included)



1/2" Wrench (Not Included)



#2 Square Drive Bit (Not Included)

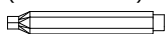

Cordless Drill (Not Included)

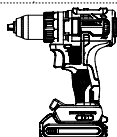

- Hardware**
- 2 - 5/16" x 3 1/2" Stainless Wafer Bolts
  - 8 - 5/16" x 2" Stainless Wafer Bolts
  - 6 - Nuts
  - 10 Washers
  - 4 - 2" Screws
  - 4 - 1 1/2" Screws
  - 1 - Set Swing Chains
  - 1 - 5/32 Hex Key

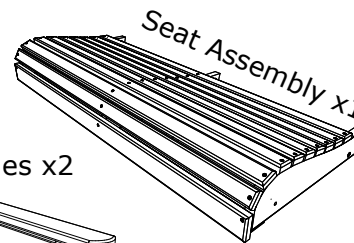

Back Assembly x1

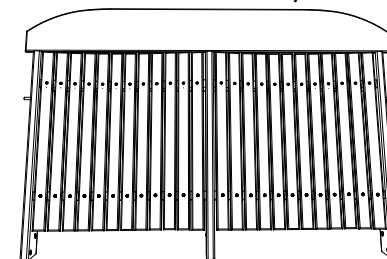

Armrest Assemblies x2

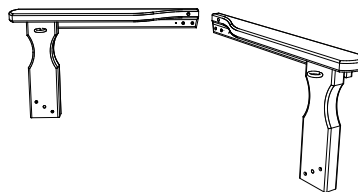

**1. Attach Back Assembly to Seat Assembly** using 6 - 2" Wafer Bolts, be sure to match all letters, tighten Wafer Bolts with included Hex Key.

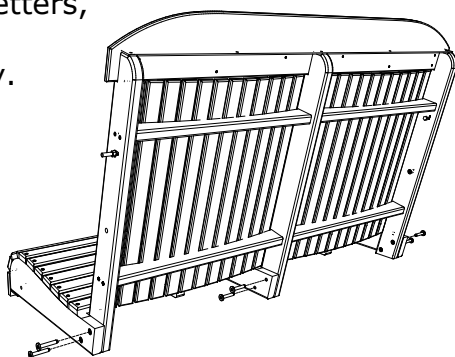

**2. Attach Armrest's** using 1 - 2" Wafer Bolt 1 - 3 1/2" Wafer Bolt 1 - Washer 1 - Nut 2 - 2" Screws & 2 - 1 1/2" Screws per side, be sure to match all letters, tighten Wafer Bolt with included Hex Key.

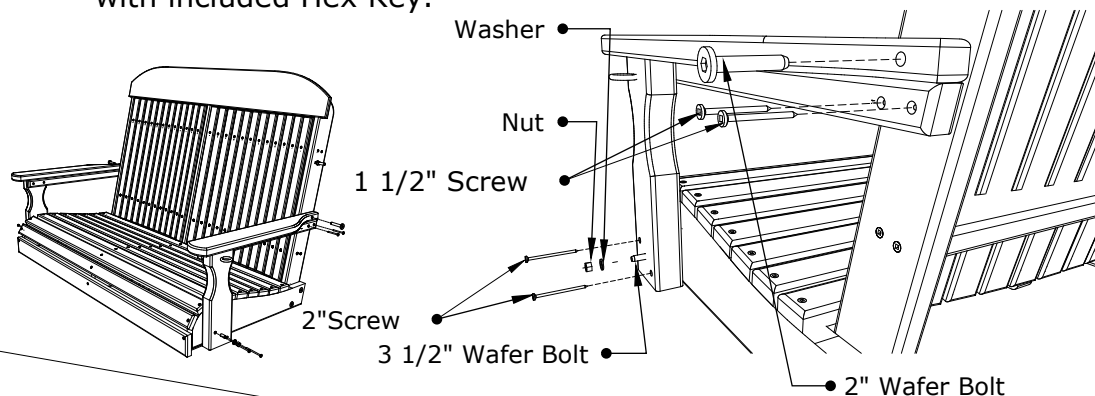

**3. Attach short end of Chain** to back of Armrest assemblies & other end through screw eye to bottom of front upright using 4 Washers & 2 nuts per side.

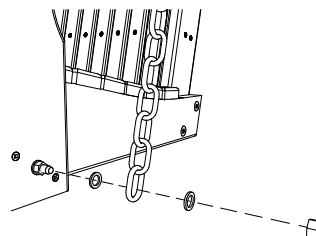
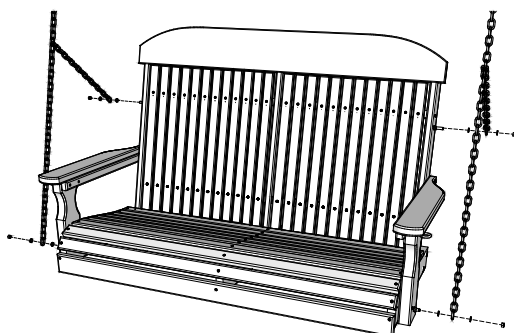

4' Classic Poly Swing Assembly Instructions

11/13/ 2024

R.M.