



Tools Required

5/32 Hex Key (Included)



1/2" Wrench (Not Included)



#2 Square Drive Bit (Not Included)

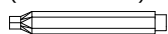

Cordless Drill (Not Included)

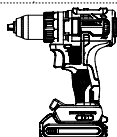

Hardware
 2 - 5/16" x 3 1/2" Stainless Wafer Bolts
 8 - 5/16" x 2" Stainless Wafer Bolts
 6 - Nuts
 10 Washers
 4 - 2" Screws
 4 - 1 1/2" Screws
 1 - Set Swing Chains
 1 - 5/32 Hex Key

Armrest Assemblies x2

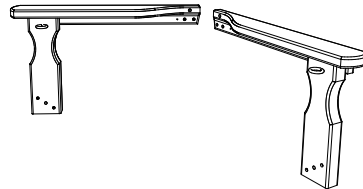

Seat Assembly x1

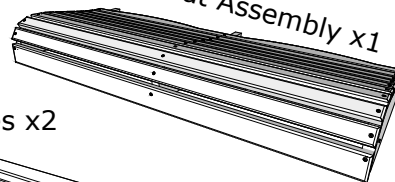

Back Assembly x1

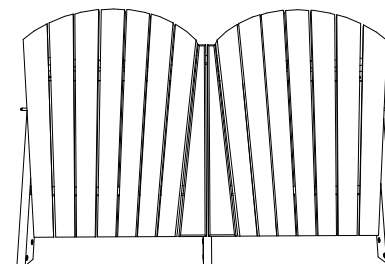

1. Attach Back Assembly to Seat Assembly using 6 - 2" Wafer Bolts, be sure to match all letters, tighten Wafer Bolts with included Hex Key.

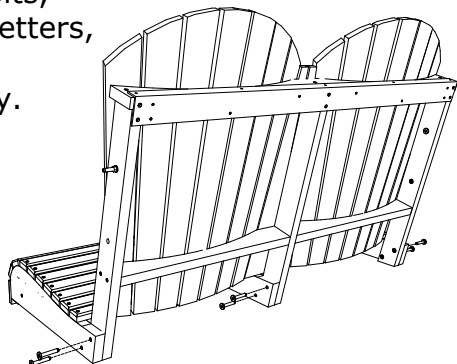

2. Attach Armrest's using 1 - 2" Wafer Bolt 1 - 3 1/2" Wafer Bolt 1 - Washer 1 - Nut 2 - 2" Screws & 2 - 1 1/2" Screws per side, be sure to match all letters, tighten Wafer Bolt with included Hex Key.

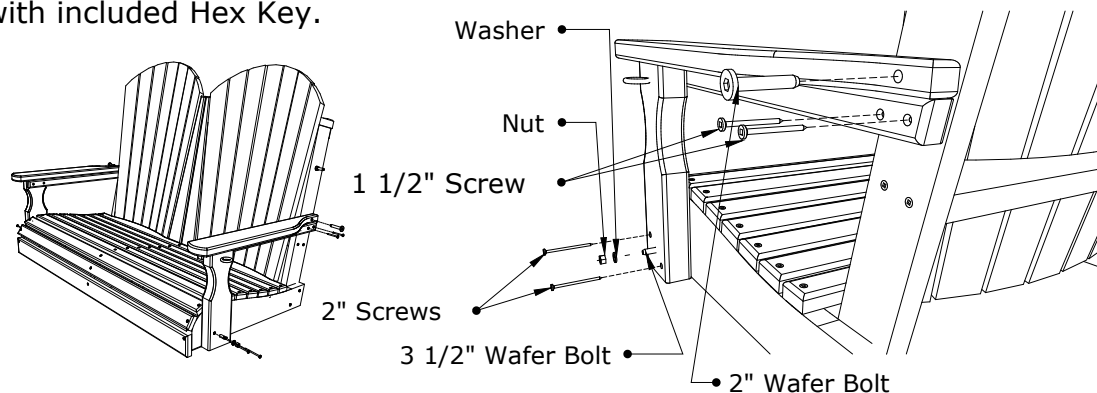

3. Attach short end of Chain to back of Armrest assemblies & other end through screw eye to bottom of front upright using 4 Washers & 2 nuts per side.

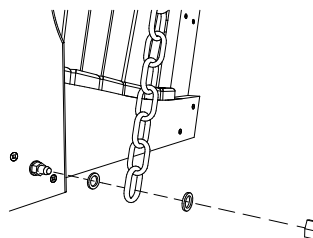
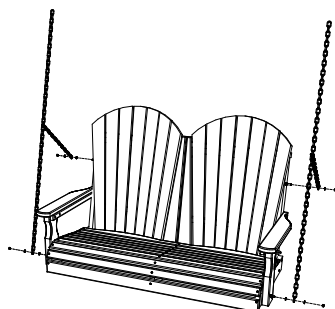

4' Adirondack Poly Swing Assembly Instructions

11/13/ 2024

R.M.