

# ARTIFEX

## ASSEMBLY GUIDE

### Rollback Swivel Glider

#### WHAT'S INCLUDED

- (6) 1/4" x 3" Wafer Head Bolts (**Steps 1-2**)
- (4) 1/4" x 4" Wafer Head Bolts (**Step 2**)
- (4) 5/16" x 2 1/2" Carriage Bolts (**Step 3-5**)
- (10) 1/4" Flange Nuts (**Steps 1-2**)
- (8) 5/16" Lock Nuts (**Steps 4-5**)
- (4) 5/16" Flange Nuts (**Step 3-5**)
- (4) Glider Arms (**Step 4-5**)
- Allen Wrench

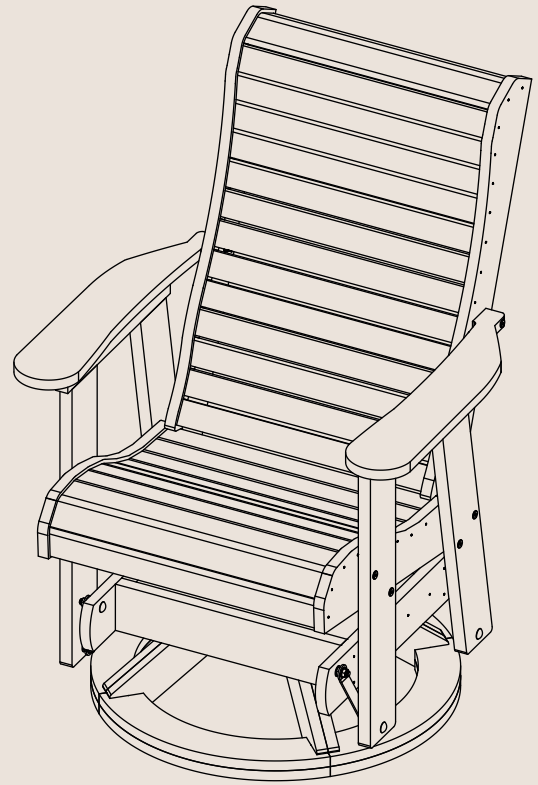
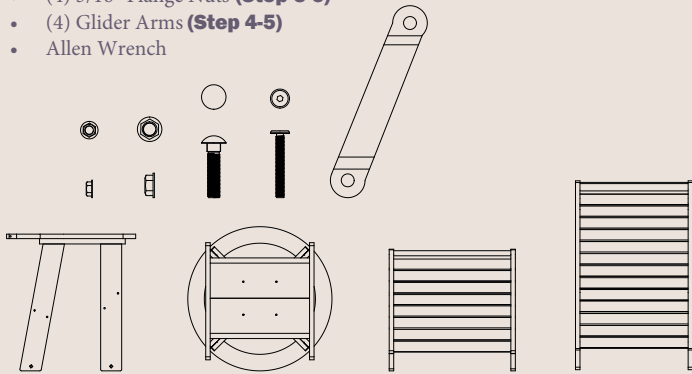

#### STEPS

#### 1 ATTACH LEGS TO SEAT

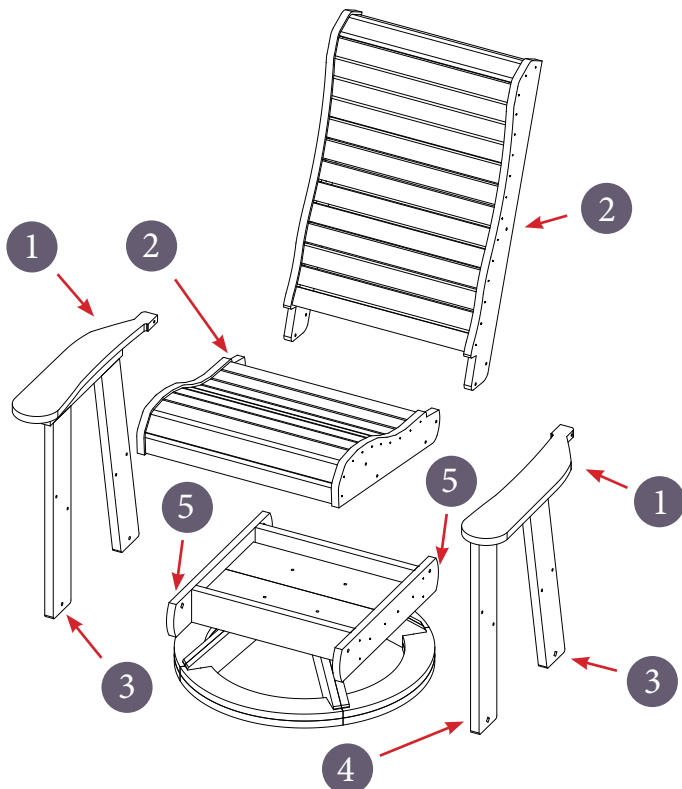

Use 4 of the 1/4 x 3" Wafer Head Bolts as shown utilizing the provided 5/32" Allen Bit.

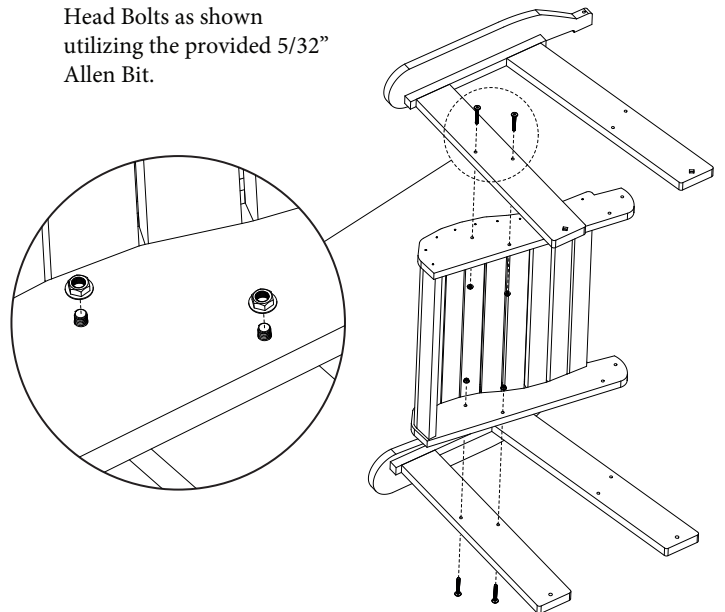

#### PRO TIP:

Prior to assembling this product, it is recommended to verify that all components are removed from packaging, and assemble on a furniture blanket. This cautionary step helps prevent any inadvertent damage to the flooring, or furniture during the assembly process.

## 2 INSTALL BACK ASSEMBLY

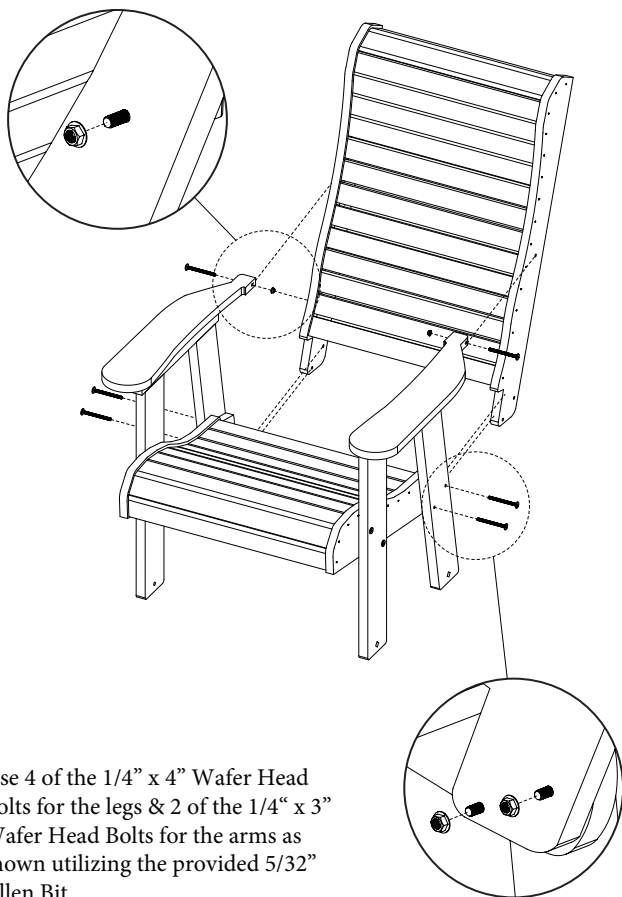

Use 4 of the 1/4" x 4" Wafer Head Bolts for the legs & 2 of the 1/4" x 3" Wafer Head Bolts for the arms as shown utilizing the provided 5/32" Allen Bit.

## 3 INSTALL CARRIAGE BOLTS

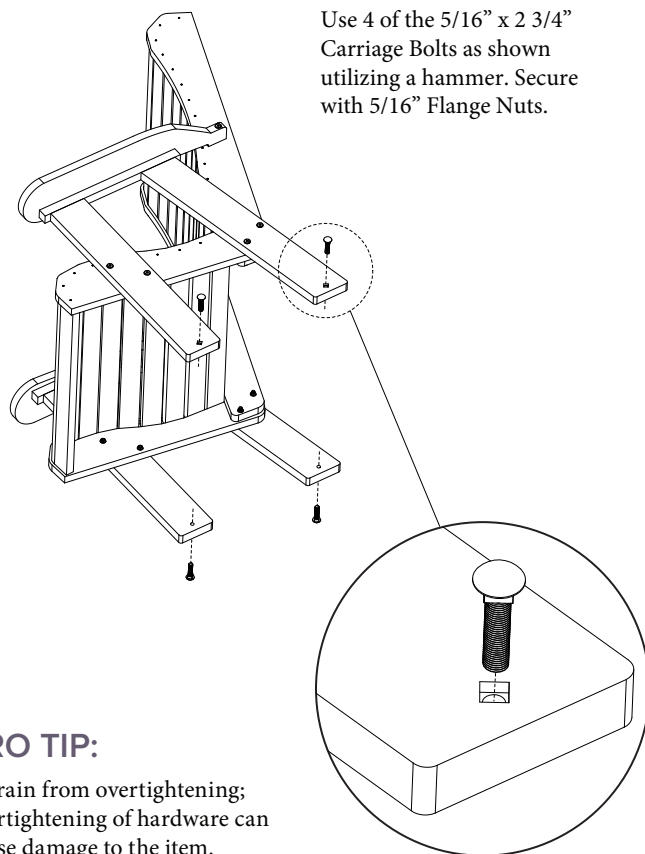

Use 4 of the 5/16" x 2 3/4" Carriage Bolts as shown utilizing a hammer. Secure with 5/16" Flange Nuts.

### PRO TIP:

Refrain from overtightening; overtightening of hardware can cause damage to the item.

## 4 INSTALL GLIDER ARMS

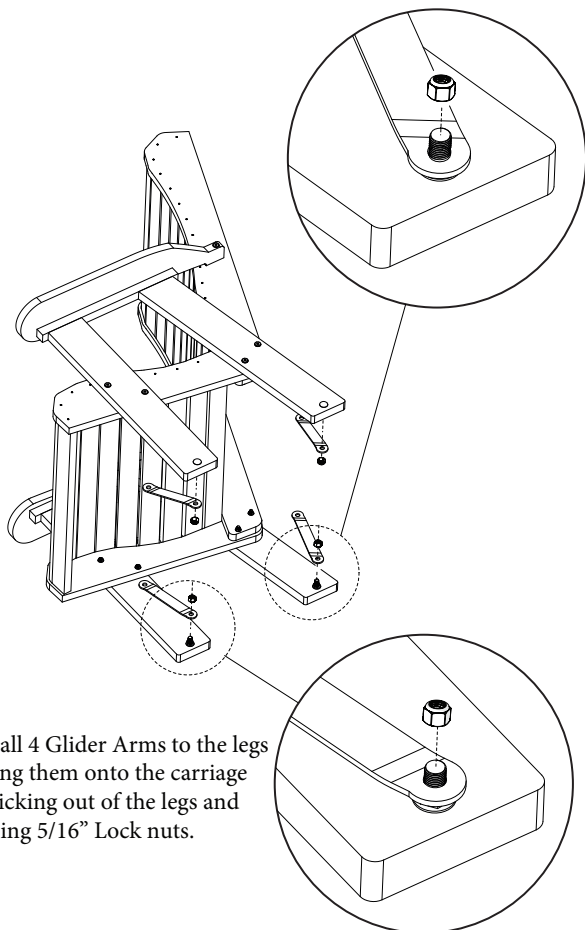

Attach all 4 Glider Arms to the legs by sliding them onto the carriage bolts sticking out of the legs and then using 5/16" Lock nuts.

## 5 INSTALL SWIVEL GLIDER BASE

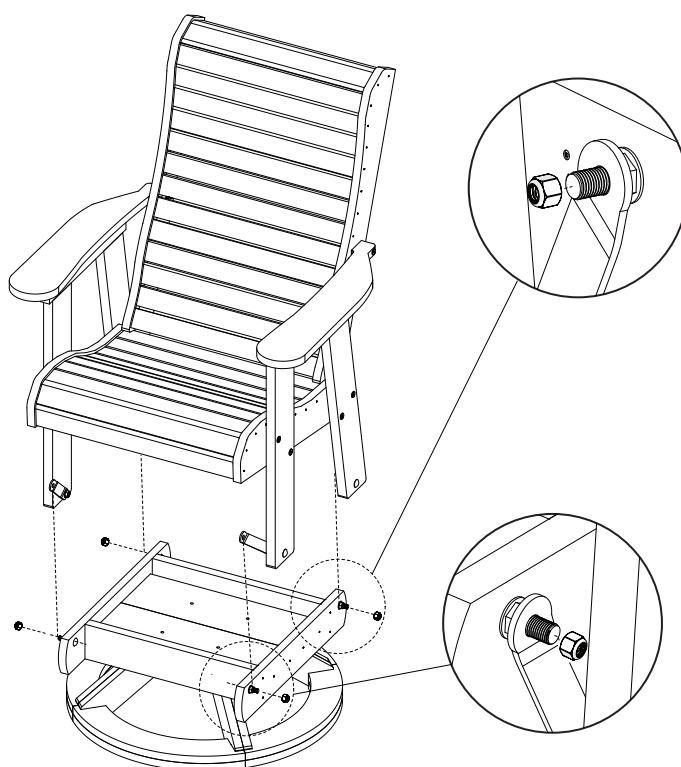

Ten attach the Glider Arms to all 4 carriage bolts on the base and finally securing them with 5/16" Lock nuts.